

Keep your edge<sup>®</sup>

# ACCUSHARP<sup>®</sup>

Sharpeners | Knives | Multi-tools



Learn More



**SAFE**



**ERGONOMIC  
HANDLE**

**QUICK**



**SHARPENS  
IN 10 SECONDS  
OR LESS**

**SIMPLE**



**EASY TO USE**

**INDUSTRIAL  
STRENGTH  
WILL LAST  
FOR YEARS!**

**The last knife sharpener  
you will ever need...**



Est. 1984

# CATALOG



## ***Making Quality Sharpening Products, Knives and Multi-Tools since 1984***

Fortune Products, Inc., dba AccuSharp Int'l, is a leading manufacturer of sharpeners, knives, and multi-tools, and a provider of quality products. We focus on making the most effective knife and tool sharpeners in the world. Every effort goes into creating products that will provide the sharpest edge possible for your knives, tools, and equipment. Whether your sharpening needs range from the kitchen, workshop, yard, hunting, fishing, or other outdoor activities, our sharpening products can help you maintain the very best edge. We are proud of the many awards we've won for product effectiveness, even when compared to brands costing hundreds more.



# Table of Contents

Knife & Tool Sharpeners
Knives & Multi-Tools
Specialty Products
Product Displays
Promotional Products

## New Products

001C AccuSharp® Knife and Tool Sharpener	6
040C AccuSharp® PRO Knife and Tool Sharpener	6
008C AccuSharp® OD Green Knife and Tool Sharpener	7
005C AccuSharp® Camouflage Knife and Tool Sharpener	7
014C AccuSharp® Blaze-Orange Knife and Tool Sharpener	7
002C ShearSharp® Scissors Sharpener	8
006C GardenSharp® Tool Sharpener	8
007C AugerSharp® Tool Sharpener	9
012C AccuSharp® Knife and Scissors Sharpeners Combo	9
100C, 101C, 102C AccuSharp® All-in-1 Pruner, Knife, and Tool Sharpener	10
1003C AccuSharp® Axe & Tool Sharpener	11
1012C AccuSharp® Lawn Mower Blade & Garden Tool Sharpener	11
129C AccuSharp® Gourmet 15° Knife Sharpener	12
126C AccuSharp® Gourmet Multi-Angle 9° Butcher Sharpening Steel	12
128C AccuSharp® Gourmet 15° Dual-angle Knife & Scissors Sharpener	13
052C AccuSharp® Gourmet 15° Pull-Through Knife Sharpener	13
036C, 039C AccuSharp® Pull-Through Knife Sharpener	14
080C, 081C AccuSharp® Compact Pull-Through Knife Sharpener	15
334C, 336C AccuSharp® Sharp N Easy® 2-Step Ceramic Knife Sharpener	16
342C, 344C AccuSharp® 2-Step Carbide-Ceramic Knife Sharpener	17
017C AccuSharp® Diamond PRO 2-Step Knife Sharpener	18
004C SturdyMount® Knife Sharpener	18
051C AccuSharp® Diamond Paddle Sharpener	19
013C AccuSharp® Broadhead Sharpener and Wrench	19
735C AccuSharp® Explorer Outdoor Survival Tool with Built-in Knife & Tool Sharpener	20
028C, 029C AccuSharp® 4-in-1 Knife & Tool Sharpener	21
050C AccuSharp® Diamond Compact Sharpener	22

4-5	030C AccuSharp® Diamond Rod Sharpener
6	032C AccuSharp® 9" Sharpening Steel
6	034C AccuSharp® 9" Diamond Sharpening Steel
7	027C AccuSharp® Diamond Pocket Stone
7	024C AccuSharp® Natural Arkansas Pocket Stone
7	023C AccuSharp® Arkansas Whetstone
8	Combination Knife Sharpening Kit
8	130C AccuSharp® 6" (Dual-Sided) Sharpening Stone
9	025C AccuSharp® DELUXE Tri-Stone Sharpening System
9	064C AccuSharp® Tri-Stone Sharpening System
9	059C AccuSharp® 5-Stone Precision Knife Sharpening Kit
10	060C AccuSharp® 3-Stone Precision Knife Sharpening Kit
11	003C AccuSharp® Tungsten Carbide Replacement Blades
11	068C AccuSharp® Honing Solution
12	135C AccuSharp® Electric Knife Sharpener
12	136C AccuSharp® Rechargeable Cordless Knife Sharpener
12	137C AccuSharp® 4-Stone Rolling Knife Sharpener
13	138C AccuSharp® 2-Stone Rolling Knife Sharpener
13	741C, 743C AccuSharp® 3.5" Replaceable Blade Razor Knife
13	742C, 744C AccuSharp® 6-Pack 3.5" Replacement Blades for the Replaceable Blade Razor Knife
14	748C AccuSharp® 3" Replaceable Blade Razor Knife
15	749C AccuSharp® 6-Pack 3" Replacement Blades for the Replaceable Blade Razor Knife
16	701C, 703C, 704C, 709C AccuSharp® Folding Sport Knife
17	711C, 712C, 713C AccuSharp® Lockback Knife
18	801C ParaForce® Lockback Knife
18	734C AccuSharp® AccuZip Skinning Knife
19	731C AccuSharp® Caping Knife
19	729C AccuSharp® Gut Hook Knife
19	732C AccuSharp® Butcher Knife
19	730C AccuSharp® Bone Saw
20	728C AccuSharp® Game Processing Kit
21	738C AccuSharp® 6-Piece Processing Kit
22	736C AccuSharp® Fillet Knife Plus 2-Step Ceramic Knife Sharpener

22	737C AccuSharp® 6-Piece Fillet Knife Kit	36
23	041C, 042C, 043C, 044C, 045C, 046C AccuSharp® Folding Sport Knife Combo Packs	37
23	716C, 717C, 718C, 721C, 722C, 723C AccuSharp® Lockback Knife Combo Packs	37
23	810C, 815C ParaForce® Lockback Knife Combo Packs	38
24	800C ParaForce® Multi-Tool	38
24	084C AccuSharp® Gardener's Multi-Tool	39
25	085C AccuSharp® Sportsman's Multi-Tool	39
25	802C ParaForce® 15-Function Multi-Tool	39
26	1020C The Big Bobber Floating Cooler	40
26	1021C Hydration Station Cooler Float	41
27	1022C Cooler & Float Bundle	41
27	1006C, 1007C Super Snaps Tarp Clip and Grommet Replacement	42
28	1008C Super Snaps XL Tarp Clip and Grommet Replacement	42
28	069Tray AccuSharp® Knife and Tool Sharpener 12-Piece Tray	43
29	082Tray, 083Tray AccuSharp® Compact Pull-Through Knife Sharpener 6-Piece Tray	43
30	334CD, 335CD AccuSharp® Sharp N Easy® 2-Step Knife Sharpener 24-Piece Counter Displays	44
30	343CD, 345CD AccuSharp® 2-Step Carbide-Ceramic Knife Sharpener 24-Piece Counter Displays	44
31	016Tray AccuSharp® Diamond PRO 2-Step Knife Sharpener 12-Piece Tray	45
31	745PDQ, 746PDQ AccuSharp® 6-Piece Replaceable Blade Razor Knife Plus Blades PDQ	46
32	800MTS ParaForce® Multi-Tool 18-Piece Counter Display	47
33	801LBKS ParaForce® Lockback Knife 18 Piece Counter Display	47
34	AccuSharp® Side Kick Floor Display	48
34	AccuSharp® Wing Rack Floor Display	48
34	AccuSharp® Rack Display	49
34	AccuSharp® Point of Purchase (POP) Display	49
35	STAND OUT to your customers with Custom Imprints!	50 & 51
36		

AccuSharp® Electric Knife Sharpener (135C)



Page 28

AccuSharp® Cordless Electric Knife Sharpener (136C)



Page 28

AccuSharp® 4-Stone Rolling Knife Sharpener (137C)



Page 29

AccuSharp® 2-Stone Rolling Knife Sharpener (138C)



Page 29



## AccuSharp® Knife and Tool Sharpener

Finally, a knife sharpener anyone can use. Easily sharpen knives (even serrated knives), cleavers, axes, machetes, and many other cutting tools in just seconds. The large, ergonomic handle fits either hand comfortably and features a full-length finger guard to safely protect your fingers while using. The reversible sharpening blades are made of diamond-honed tungsten carbide and provide years of reliable use. The original AccuSharp® comes in white, brushed aluminum, blaze-orange, olive drab green, and camouflage. Replacement blades are sold separately.



(001C)



Scan to see how it works.



(Case Packs)



(069Tray)



## AccuSharp® PRO Knife and Tool Sharpener



Scan to see how it works.



(040C)



This chic AccuSharp® PRO is sure to impress and fits seamlessly into any kitchen with the same award-winning features as the 001C AccuSharp®.



## AccuSharp® Camouflage Knife and Tool Sharpener



Scan to see how it works.



(005C)

MADE IN THE USA

## AccuSharp® Blaze-Orange Knife and Tool Sharpener



(014C)

MADE IN THE USA



Scan to see how it works.

## AccuSharp® OD Green Knife and Tool Sharpener



(008C)

MADE IN THE USA



## ShearSharp® Scissors Sharpener

ShearSharp® Scissors Sharpener sharpens general purpose scissors, hedge clippers, and tin snips. If you own a pair of scissors, you will want to have the easy-to-use, affordable ShearSharp® Scissors Sharpener. The sharpening blade is diamond-honed tungsten carbide and provides years of reliable use.



(002C)



Scan to see how it works.



## GardenSharp® Tool Sharpener

The GardenSharp® Tool Sharpener is designed to sharpen all single-beveled edge and hard-to-sharpen items in your tool shed like lawn mower blades, pruning shears (secateurs), limb loppers, hoes, shovels, and scythes. Ideal for florists, landscapers, and gardeners, the GardenSharp® Tool Sharpener is a must-have!



(006C)



Scan to see how it works.



## AugerSharp® Tool Sharpener

The ice fisherman's dream lets you spend more time fishing and less time drilling holes in the ice. Ideal for all single-beveled edges.



(007C)

MADE IN THE USA



## AccuSharp® Knife and Scissors Sharpeners Combo

Sharpen nearly anything in the house. This combo pack consists of the AccuSharp® Knife & Tool Sharpener and the ShearSharp® Scissors Sharpener.



(012C)

MADE IN THE USA



Scan to see how they work.

# AccuSharp® All-in-1 Pruner, Knife, and Tool Sharpener

The AccuSharp® All-in-1 Pruner, Knife, and Tool Sharpener is custom-made for sharpening pruners, loppers, shears, knives, axes, hatchets, mower blades, scissors, and any other single-beveled or double-beveled tools with just a few strokes. The pre-angled diamond-honed tungsten carbide blades are exactly what you need to restore and sharpen your edge every time you need it. Available in blue, green, and orange.

## Sharpens:



Lawn Mower Blades



(100C)



(101C)



(102C)



Use to Sharpen Double Beveled Edge Blades (Axes and Knives)



Use to Sharpen Single Beveled Edge Blades (Pruners, Lawn Mower Blades, etc.)



Use to Sharpen Scissors

## Sharpens:

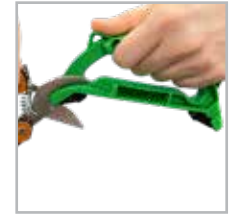

Pruners



Knives



Scissors



Hatchets



## AccuSharp® Axe & Tool Sharpener

The Axe & Tool Sharpener is quick and easy to use. This sharpener is excellent for sharpening axes and other large garden tools. The pre-angled tungsten carbide inserts make quick work of sharpening your garden tools, both single-beveled and double-beveled edges, with just a few strokes. Use Slot 1 for double-beveled edge tools like axes and hatchets. Use Slot 2 for single-beveled edge tools like mower blades, garden shears, shovels, and more.



(1003C)

MADE IN THE USA



Scan to see how it works.

## AccuSharp® Lawn Mower Blade & Garden Tool Sharpener

The Lawn Mower Blade & Garden Tool Sharpener efficiently sharpens lawn mower blades and other single-beveled garden tools. The tungsten carbide insert makes quick work of sharpening your garden tools and other single-beveled edge tools in just a few strokes.



(1012C)

MADE IN THE USA



## AccuSharp® Gourmet 15° Knife Sharpener

Introducing the AccuSharp® Gourmet 15° Knife Sharpener—the ultimate in precision for refining gourmet knives, serrated or straight-edged. With reversible diamond-honed tungsten carbide blades, ergonomic handle, and full-length finger guard, it prioritizes safety and delivers seamless operation. Rust-resistant and easy to clean, it's perfect for home and industrial kitchen use. Replacement blades are available for ongoing peak performance.



(129C)

MADE IN THE  
USA



## AccuSharp® Gourmet Multi-Angle 9” Butcher Sharpening Steel

Elevate your knives with the AccuSharp® Gourmet Multi-Angle 9” Butcher Sharpening Steel. With 15° and 21° angle guides, it suits various blade angles. Swiftly revive well-maintained edges in as few as 10 strokes. Magnetized to keep metal shavings away from food prep areas, it features a rubber over-molded handle for a secure grip. Perfect for home and industrial kitchen use.

Fine Grit: 1500



(126C)



## AccuSharp® Gourmet 15° Dual-Angle Knife & Scissors Sharpener

Introducing the AccuSharp® Gourmet 15° Dual-Angle Knife and Scissors Sharpener, crafted to effortlessly sharpen straight and serrated knives, along with scissors, with just a few swift strokes. Engineered with dual preset angles of 15° and 21°, it streamlines the sharpening process for both home and industrial-grade kitchens. Crafted from premium American-made diamond-honed tungsten carbide, the reversible blades offer twice the lifespan.



(128C)

MADE IN THE USA

## AccuSharp® Gourmet 15° Pull-Through Knife Sharpener

The AccuSharp® Gourmet 15° Pull-Through Knife Sharpener is ideal for maintaining 15° blades. Featuring diamond-coated and fine ceramic rods, it sharpens and hones with precision. The heavy-duty handle offers stability and comfort, thanks to its ergonomic design and rubber over-molded grip. This commercial-grade sharpener is the ultimate choice for keeping your gourmet knives in top condition.

Coarse Grit: 320

Fine Grit: 1500



Scan to see how it works.



(052C)

## AccuSharp® Pull-Through Knife Sharpener

This commercial-grade knife sharpener combines our diamond-honed tungsten carbide sharpening blades and fine ceramic rods. The heavy-duty ergonomically designed handle with a rubber over-molded grip provides a stable and comfortable platform for sharpening all your knives. Available in white/blue and orange/green.

Fine Grit: 1500



Scan to see how it works.



Scan to see how it works.



(036C)



(039C)



# AccuSharp® Compact Pull-Through Knife Sharpener

This compact commercial-grade knife sharpener combines our diamond-honed tungsten carbide sharpening blades and fine ceramic rods. This sharpener is perfect for sharpening and maintaining your blades. Available in white/blue and orange/green.

Fine Grit: 1500



(082Tray)



(080C)



(083Tray)



(081C)

Scan to see how it works.



# AccuSharp® Sharp N Easy® 2-Step Ceramic Knife Sharpener

The 2-Step Ceramic Knife Sharpener is an innovative tool that anyone can use. The pre-angled ceramic rods are exactly what you need to care for and maintain your blades. The two stages, dark for coarse and white for fine, allow for the proper angle every time. Available in black/blue and orange/green.

Coarse Grit: 800 | Fine Grit: 1500



(334CD)



(334C)



Scan to see how it works.



Scan to see how it works.



(335CD)



(336C)

# AccuSharp® 2-Step Carbide-Ceramic Knife Sharpener

The AccuSharp® 2-Step Carbide-Ceramic Knife Sharpener features pre-angled diamond-honed tungsten carbide blades and fine ceramic rods that will maintain an accurate edge. Just three or four strokes through the coarse slot restores the edge. Then, 3-4 strokes through the fine rods polish the edge for a smooth, sharp finish. Available in white/blue and blaze-orange.

Fine Grit: 1500



(343CD)



(342C)



(345CD)



(344C)

## AccuSharp® Diamond PRO 2-Step Knife Sharpener

This sharpener features pre-angled coarse diamond and fine ceramic rods to sharpen, restore, and polish the blade's edge. The Diamond PRO 2-Step exterior is made of brushed aluminum and finished with a rubber over-molded grip and rubber feet for safety.

Coarse Grit: 320  
Fine Grit: 1500



Scan to see how it works.



(017C)



(016Tray)

## SturdyMount® Knife Sharpener

Ideal for mounting on cutting boards, kitchen counters, fillet boards, workbenches, butcher blocks, cleaning tables, and more. The diamond-honed tungsten carbide sharpening blades are reversible and replaceable. A durable ABS plastic body and stainless steel screws make the SturdyMount® Knife Sharpener ideal for both indoor and outdoor use.



(004C)



## AccuSharp® Diamond Paddle Sharpener

This double-sided sharpener features an aggressive coarse diamond surface, a fine diamond surface for honing and finishing, and also includes a groove for sharpening hooks and darts. The folding handle allows you to fold and store your sharpener with ease.

Coarse Grit: 320

Fine Grit: 600



Scan to see how it works.



(051C)



## AccuSharp® Broadhead Sharpener and Wrench

This exceptional tool combines a sharpener and wrench, setting a new standard in the industry. Its innovative design ensures all your broadheads stay razor-sharp, making it your go-to tool of choice. The wrench is compatible with 2, 3, 4, and 5-blade broadheads. To achieve the perfect cutting edge, simply pass the blade through the two tungsten carbide blades and the ceramic honing rods three or four times on each side.

Please note that some broadheads may require disassembly for best sharpening results.

Fine Grit: 1500



MADE IN THE USA



(013C)

# AccuSharp® Explorer Outdoor Survival Tool with Built-in Knife & Tool Sharpener

With diamond-honed tungsten carbide blades and fine ceramic rods, this outdoor survival tool and sharpener keeps your knives sharp and finely honed at all times. Its unique diamond-tapered rod is perfect for sharpening gut-hook knives and serrated edges, while a central groove allows you to sharpen fishhooks and pointed objects. This multi-functional tool also features a built-in fire starter, compass, emergency whistle (tested to 120 dB), and SOS mirror, making it an indispensable companion for any outdoor adventurer.

Coarse Grit: 400  
Fine Grit: 1500

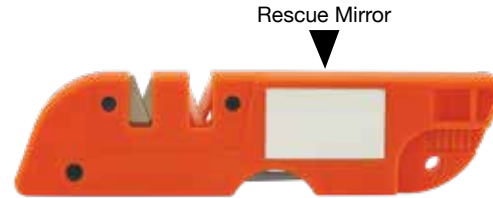

(735C)



# AccuSharp® 4-in-1 Knife & Tool Sharpener

This sharpener features tungsten carbide blades, fine ceramic rods, a retractable tapered diamond rod, and a flat diamond file, all in one pocket-sized unit. The AccuSharp® 4-in-1 Sharpener is the outdoorsmen's best friend for sharpening and honing your blades. Available in orange and black.

Coarse Grit: 400  
Fine Grit: 1500



(028C)



(029C)



Scan to see how it works.



## AccuSharp® Diamond Compact Sharpener

The AccuSharp® diamond-coated compact sharpener is a tapered, cone-shaped steel rod engineered for use on serrations and in tight spaces. This sharpener also features a groove for sharpening fish hooks and darts.

Coarse Grit: 320



(050C)



## AccuSharp® Diamond Rod Sharpener

The AccuSharp® Diamond Rod Sharpener features a diamond-coated steel rod designed to sharpen all types of knives, including those with serrated edges. Its retractable, cone-shaped tip allows you to reach serrations and other tight spaces with precision. The rod also includes a built-in groove specifically for sharpening fish hooks and darts.



Coarse Grit: 280



(030C)



Scan to see how it works.

## AccuSharp® 9" Sharpening Steel

The 9" AccuSharp® Sharpening Steel realigns the blade's edge, keeping all your household knives properly honed. The steel surface quickly returns the edge of a good blade in around 10 strokes.

Fine Grit: 1500



(032C)

## AccuSharp® Diamond Pocket Stone

The dual-sided pocket sharpening stone features both coarse and fine diamond surfaces with a groove for sharpening hooks and darts.

Coarse Grit: 320

Fine Grit: 800



(027C)



## AccuSharp® 9" Diamond Sharpening Steel

Fast-sharpening and long-lasting, the 9" AccuSharp® Diamond Sharpening Steel will keep all your household knives properly honed. The durable diamond surface restores a sharp edge in as few as 10 strokes.

Fine Grit: 1500



(034C)

## AccuSharp® Natural Arkansas Pocket Stone

The AccuSharp® Natural Arkansas Pocket Stone offers traditional sharpening for all kinds of straight-edged knives & hooks.



MADE IN THE USA

(024C)



## AccuSharp® Arkansas Whetstone Combination Knife Sharpening Kit

The AccuSharp® Whetstone Combination Knife Sharpening Kit includes two 3” sharpening stones for traditional coarse and fine sharpening, plus a 1 oz. bottle of honing oil in an organized kit.

Coarse Grit: 400–600  
Fine Grit: 800–1000



(023C)

MADE IN THE  
**USA**



## AccuSharp® 6” (Dual-Sided) Sharpening Stone

The dual-sided AccuSharp 6” Sharpening Stone combines sharpening and polishing into one cost-effective tool, perfect for maintaining tools and knives. The 6” stone made from silica oxide allows for multiple stages of sharpening without interruption—saving time and effort. Get customized sharpening for different types of blades by adjusting the pressure and angle according to your preference.

Coarse Grit: 120  
Fine Grit: 240



(130C)

## AccuSharp® DELUXE Tri-Stone Sharpening System

This rotating 6" three-stone system is equipped with coarse diamond, medium alumina oxide, and fine ceramic stones and includes a 21° angle guide. The base features slip-resistant feet, but can also be attached to a work surface if preferred.

Coarse Grit: 320  
Medium Grit: 280  
Fine Grit: 1500



(025C)



Scan to see how it works.



## AccuSharp® Tri-Stone Sharpening System

This rotating Tri-Stone Sharpening System provides extra durability and safety on any surface with a rubber-grip base that prevents sliding while sharpening and honing your blades. Also included is an angle guide to assist in maintaining a consistent angle while sharpening. The Tri-Stone sharpening system comes with three stone surfaces to choose from with the ability to quickly and easily switch between them.

Coarse Grit: 120  
Medium Grit: 180  
Fine Grit: 240



(064C)



## AccuSharp® 5-Stone Precision Knife Sharpening Kit

The 5-stone precision knife sharpening kit includes fine, medium, and coarse alumina oxide stones, an extra coarse diamond-coated stone (with a groove for hook sharpening), and a fine ceramic stone for serrated blades. The angle guide has settings at 11°, 15°, 18°, 21°, 25°, and 30° to sharpen a wide variety of knives.

Diamond Coarse Grit: 320  
Coarse Grit: 120  
Medium Grit: 180  
Fine Grit: 280  
Ceramic Fine Grit: 1500



(059C)



## AccuSharp® 3-Stone Precision Knife Sharpening Kit

The AccuSharp® 3-Stone Precision Knife Sharpening Kit is equipped with six angle guides and three sharpening options to keep your knife's edge razor sharp with fine, medium, and coarse alumina oxide stones. The angle guide has settings at 11°, 15°, 18°, 21°, 25°, and 30° angles.

Coarse Grit: 120  
Medium Grit: 180  
Fine Grit: 280



(060C)



Scan to see how it works.

## AccuSharp® Tungsten Carbide Replacement Blades

For the best possible sharpening edge, we only use the finest American-made diamond-honed tungsten carbide available. These blades are reversible for double the life. Most users report an average life of five to ten years between replacements. Beware of other brands that use inexpensive imported carbide. Insist on AccuSharp®.



(003C)

MADE IN THE USA

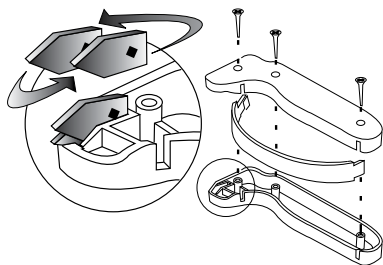

## AccuSharp® Honing Solution

AccuSharp® Honing Solution is ideal for all traditional natural stone sharpening. This solution protects stones from clogging and provides a smooth sharpening surface for your knives and tools.



(068C)

MADE IN THE USA



## AccuSharp® Electric Knife Sharpener

This motorized knife sharpener is an essential tool for both professional chefs and home cooks. It offers superior sharpening power and a smooth, consistent edge with its preset 21° angle. This electric knife sharpener includes an 800-grit diamond-coated disc, a 400-grit synthetic disc, and 6000-grit ceramic finishing rods. Rubber suction feet keep the sharpener firmly in place while you work, ensuring stability and safety.



(135C)



## AccuSharp® Electric Cordless Knife Sharpener

This cordless electric knife sharpener is a must-have for both professional chefs and home cooks. It features a smooth, consistent sharpening motion with a precise 21° angle. Lightweight and user-friendly, it includes an ergonomic handle, a durable 400-grit diamond-coated disc, and rubber suction feet to keep it stable and secure during use. This combination ensures both safety and efficiency in maintaining your knives.



(136C)



## AccuSharp® 4–Stone Rolling Knife Sharpener

The 4–Stone Rolling Knife Sharpener features dual sharpening stones that quickly restore dull blades and eliminate burrs. Its user-friendly design includes a detachable magnetic knife base that accommodates various blade heights and can store extra sharpening stones. With four pre-set sharpening angles (15°, 17°, 20°, and 25°), it's ideal for both everyday kitchen knives and specialty blades.

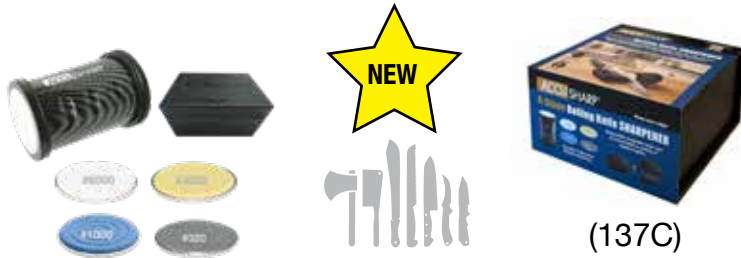

## AccuSharp® 2–Stone Rolling Knife Sharpener

Restore dull knives in seconds at home. Featuring preset magnetic angle guides and dual-sided coarse and fine sharpening discs, this easy-to-use rolling sharpener delivers consistent, razor-sharp edges with no experience required. The detachable magnetic base supports multiple sharpening angles (15°, 17°, 20°, and 25°) for kitchen, chef, santoku, and utility knives, while the compact design stores easily in any drawer.



## AccuSharp® 3.5" Replaceable Blade Razor Knife

A great knife for camping, hiking, and everyday carry. This knife includes 2 extra replacement blades that allow you to quickly change out your dull blade within seconds using the innovative quick-release lever. The push-button on the side allows you to lock your blade into three locking positions (110°, 145°, 180°). Measuring 8.5" when opened, the Replaceable Blade Razor Knife is made with a 3.5" 420 stainless steel blade and an ergonomically designed handle for ease of use. Available in either blue or blaze-orange.



(741C)



(743C)



**Actual Size:**  
8.5" Open  
4.875" Closed  
3.5" Blade

## AccuSharp® 6-Pack 3.5" Replacement Blades for the Replaceable Blade Razor Knife

Quickly change out dull blades with these 3.5", 420 stainless steel replacement blades made to fit the AccuSharp® Replaceable Blade Razor Knife. Use the quick-release lever on the blade holder to release the dull blade and replace with the sharper replacement blade; press the quick-release lever down to lock the blade in place.



(742C)



(744C)



## AccuSharp® 3" Replaceable Blade Razor Knife

Introducing the AccuSharp® 3" Replaceable Blade Razor Knife: a versatile pocket companion for everyday carry. This adaptable knife comes with two extra blades, allowing you to easily exchange dull ones using the innovative quick-release lever. The push-button on the side allows you to lock your blade into three locking positions (110°, 145°, 180°). With a length of 7.5" when unfolded, this knife features a 3" 420 stainless steel blade and an ergonomically designed non-slip handle for comfortable handling. Perfect for camping, hiking, or everyday use, it seamlessly blends functionality with aesthetics, providing exceptional cutting performance when you need it.

### Actual Size:

7.5" Open  
4.5" Closed  
3" Blade



(748C)



## AccuSharp® 6-Pack 3" Replacement Blades for the Replaceable Blade Razor Knife

Easily replace dull blades with these 3" 420 stainless steel replacement blades, designed for the AccuSharp® 3" Replaceable Blade Razor Knife. Simply use the quick-release lever on the blade holder to remove the old blade and insert a new, sharper one. Press the quick-release lever down to secure the new blade in place.



(749C)



## AccuSharp® Folding Sport Knife

This knife is constructed of anodized aluminum and stainless steel, providing years of rust-free use. The belt clip ensures that this knife will always be by your side when you need it. The wheel lock feature keeps this knife securely locked open or closed, and includes a glass breaker for emergencies and rescue. A great pocket-knife for camping, hiking, and everyday carry. Available in blue, black, camouflage, and orange.



(701C)



(703C)



(704C)



(709C)

**Actual Size: 7" Open | 4" Closed | 3" Blade**

## AccuSharp® Lockback Knife

This lightweight stainless steel knife features a removable one-hand opening pin, Allen wrench, safety lock, and a comfortable G10 handle grip in three of our top-selling colors: black, blaze-orange, and camouflage.

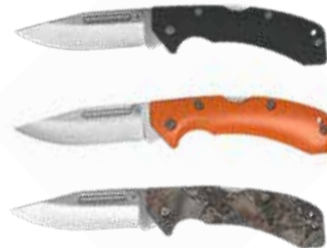

(711C)



(712C)



(713C)

**Actual Size: 8" Open | 4.5" Closed | 3.5" Blade**

## ParaForce® Lockback Knife

The ParaForce® Lockback Knife is lightweight, durable, and ideal for everyday carry. This folding knife features a belt clip, 3" 420 stainless steel blade, and a safety lock. This handy knife fits comfortably in your pocket and safely in the palm of your hand.



(801C)

**Actual Size:**  
7" Open  
4" Closed  
3" Blade



## AccuSharp® AccuZip® Skinning Knife

This 420 stainless steel game processing knife features a blunt tip that prevents the knife from puncturing internal organs which can spoil the meat. Made with an ergonomically designed handle in blaze-orange, this knife includes a nylon sheath with belt loop.



(734C)

**Actual Size:**  
9" Total  
4" Blade



## AccuSharp® Caping Knife

The AccuSharp® Caping Knife features a finer edge with a smaller razor-sharp blade. This 420 stainless steel knife is strong and durable, making your game processing a breeze. The blaze-orange handle is made with a non-slip rubber grip for comfort and ease of handling. This knife comes with a nylon sheath with belt loop.



(731C)

**Actual Size:**  
8.5" Total  
4" Blade

## AccuSharp® Butcher Knife

The AccuSharp® Butcher Knife is primarily used for cutting through thick cuts of meat and bone. This 420 stainless steel knife is strong and durable, making your game processing a breeze. The ergonomically designed handle in blaze-orange is made with a non-slip rubber grip for comfort and ease of use. This knife comes with a nylon sheath with belt loop.



(732C)

**Actual Size:**  
9" Total  
4" Blade

## AccuSharp® Gut Hook Knife

A good field dressing knife, the AccuSharp® Gut Hook Knife features a 420 stainless steel blade that is strong and durable, making the process of opening the body cavity a breeze. The blaze-orange handle is made with a non-slip rubber grip for comfort and ease of handling. This knife comes with a nylon sheath with belt loop.



(729C)

**Actual Size:**  
8.5" Total  
3.5" Blade

## AccuSharp® Bone Saw

The 6" Bone Saw is a practical and essential field tool for tackling many tasks. Designed with a textured T-Shaped handle in blaze-orange, machined finger grooves with non-slip rubberized grip, and a 6" 420 stainless steel saw blade; this highly visible, compact and lightweight bone saw is built for the demands of the outdoors. This saw comes with a nylon sheath with belt loop.



(730C)

**Actual Size:**  
9.5" Total  
6" Blade

## AccuSharp® Game Processing Kit

Control exactly how your game is processed with the AccuSharp® Game Processing Kit. The complete set of tools and accessories allow you to process your game like a pro. Our game processing kit includes a butcher knife, caping knife, gut hook knife, bone saw, rib cage spreader, zip ties, gloves, a hard-side carry case, and our award-winning AccuSharp® Knife and Tool Sharpener to keep your edge. Our 420 stainless steel knives are made with a wide, ergonomically designed, non-slip rubber-grip handle for comfort and ease of handling.



(728C)



Scan to see how it works.



Includes the Award-Winning AccuSharp® Knife Sharpener



## AccuSharp® 6-Piece Processing Kit

The AccuSharp® 6-Piece Processing Kit is everything you need when it comes to field dressing. This 6-piece kit comes with a 3" caping knife, 4" butcher knife, 4" AccuZip skinning knife, LED head lamp with 4-light modes, 2-step carbide-ceramic knife sharpener to help maintain your blades, and a compact nylon carrying case. Our 420 stainless steel knives are made with a wide, ergonomically designed, non-slip rubber grip handle for comfort and ease of handling.



(738C)



## AccuSharp® Fillet Knife Plus 2-Step Ceramic Knife Sharpener

This lightweight, 6.5” single blade fillet knife, is a great choice for maneuvering the contours of the fish for carving out perfect fillets. This full-tang fillet knife is made from satin-finished stainless steel coated with titanium to strengthen the cutting edge against premature wear. The fish scale design on the non-slip grip handle features an over-molded TPR surface for a secure and comfortable grip while handling the knife. This knife comes with a knife sheath and our AccuSharp® 2-Step Ceramic Knife Sharpener to help you keep your edge.



(736C)



## AccuSharp® 6-Piece Fillet Knife Kit

This 6-piece kit comes with an 8”, 6.5”, 5.5”, and 4.75” fillet knives. These full-tang fillet knives are made from satin-finished stainless steel coated with titanium to strengthen the cutting edge against premature wear. The fish scale design on the non-slip grip handle features an over-molded TPR surface for a secure and comfortable grip while handling the knife. Comes with a nylon carry case and our AccuSharp® 2-Step Carbide-Ceramic Knife Sharpener to help you keep your edge.



(737C)



## AccuSharp® Folding Sport Knife Combo Packs

We've combined the AccuSharp® Folding Sport Knife with our award-winning AccuSharp® Knife and Tool Sharpener and the AccuSharp® 2-Step Ceramic Knife Sharpener to help you keep your *edge*®. Constructed of anodized aluminum with a 420 stainless steel blade, this knife will provide years of rust-free use.



(041C)



(042C)



(043C)



(044C)



(045C)



(046C)

## AccuSharp® Lockback Knife Combo Packs

We've got your back! To ensure your lockback always has a sharp edge, we've combined the AccuSharp® Lockback Knife with our award-winning AccuSharp® Knife and Tool Sharpener and the AccuSharp® 2-Step Ceramic Knife Sharpener. The distinctive handle provides for a comfortable grip while the lockback feature securely holds the blade open for safe use. If necessary, remove the opening pins on both sides of the blade easily using the enclosed Allen wrench.



(716C)



(717C)



(718C)



(721C)



(722C)



(723C)

## ParaForce® Lockback Knife Combo Packs

To keep your lockback sharp, we've combined the ParaForce® Lockback Knife with our AccuSharp® Sharp N Easy® 2-Step Ceramic Knife Sharpener to help you keep your edge®. This lockback knife features a belt clip, 3" 420 stainless steel blade, and a safety lock. This handy knife fits comfortably in your pocket and safely in the palm of your hand.



(810C)

Pairing the ParaForce® Lockback Knife with the ParaForce® Multi-Tool ensures that you have the necessary tools when you need it. This handy knife and multi-tool is compact and perfect for everyday carry.



(815C)

## ParaForce® Multi-Tool

The ParaForce® Multi-Tool features 13 tools in one. A handy pocket tool to have around for the times when you need one. This multi-tool set comes with: Needle Nose Pliers, Regular Pliers, Scissors, Sharp Knife, Bottle Opener, Phillips Screwdriver, Serrated Knife, Can Opener, Nail Cleaner, Nail File, Small Screwdriver, Medium Screwdriver, and a Large Screwdriver.



Actual Size:  
4.25" Open  
2.75" Closed

(800C)

18 piece case pack in assorted colors

## AccuSharp® Gardener's Multi-Tool

The AccuSharp® Gardener's Multi-Tool features 10 tools in one. If you are an avid gardener, this is the multi-tool to have around. This multi-tool set comes with: Pruner, Phillips Screwdriver, Phillips Screwdriver, Small Screwdriver, Nail File (double-sided), Large Screwdriver, Saw, Sharp Knife, Scraper, Ruler, and Nail/Staple Remover. This multi-tool is great for your home and gardening needs.



(084C)



Actual Size:  
6.25" Open  
4" Closed

## AccuSharp® Sportsman's Multi-Tool

The AccuSharp® Sportsman's Multi-Tool features 11 tools in one. If you are an avid sportsman, this is the multi-tool for you. This multi-tool set comes with: Pruner, Phillips Screwdriver, Small Screwdriver, Nail File (double-sided), Large Screwdriver, Saw, Sharp Knife, Fish Scaler, Ruler, and Nail/Staple Remover. This multi-tool is great for tackling any outdoor activity.



(085C)



Actual Size:  
6.25" Open  
4" Closed

## ParaForce® 15-Function Multi-Tool

The ParaForce® Multi-Tool packs 15 tools into one compact device, making it perfect for DIY enthusiasts. It includes Needle Nose Pliers, Regular Pliers, Wire Cutter, Sharp Knife, Bottle Opener, Phillips Screwdriver, Boning Saw, Can Opener, Fish Scaler, Nail File, and three Screwdrivers (Small, Medium, and Large), along with a Nail Remover and Ruler.



(802C)

Actual Size:  
6" Open  
4" Closed



# The Big Bobber Floating Cooler™

Capture everyone's attention with the Big Bobber Floating Cooler! Keep your drinks cool by your side or out on the water! A great gift for the person who has everything! Great for fishermen, pools and hot tubs, rafting and float tubes, and the great outdoors. A must for every outdoor enthusiast!

Visit [bigbobbercooler.com](http://bigbobbercooler.com) for more information.



(1020C)



Scan to see how it works.

MADE IN THE USA



## The Hydration Station Innettube Float

Introducing the Hydration Station – your ultimate water companion! Built for the Big Bobber Floating Cooler, this durable float is perfect for tubing, fishing, or any outdoor adventure. Made from phthalate-free 0.5 mm PVC, it supports up to 100 lbs. and features a mesh bottom, two handles, four cup holders, and two rope ties for secure attachment. Keep the good times flowing and stay refreshed with the Hydration Station!



(1021C)



## The Big Bobber Floating Cooler Hydration Station



Keep everyone refreshed and your drinks close at hand with this cooler and float bundle. Perfect for any outdoor adventure, the Hydration Station Float and Big Bobber Floating Cooler are designed to work together seamlessly.



(1022C)



## Super Snaps Tarp Clip and Grommet Replacement

Super Snaps Tarp Clip and Grommet Replacement are ideal for securing tarps. Designed to withstand the outdoor elements, Super Snaps are great for the home, marine, ranch, camping, and more!



(1006C)



(1007C)

MADE IN THE USA



## Super Snaps XL Tarp Clip and Grommet Replacement

Super Snaps XL Tarp Clip and Grommet Replacement provide extra strength holding power for securing tarps. Designed to withstand the outdoor elements, Super Snaps XL is great for DIY projects, RVers, boaters, campers, motorcyclists, construction trades, farmers and ranchers, and more!



(1008C)

MADE IN THE USA



# AccuSharp® Knife and Tool Sharpener 12-Piece Tray

Sharpen knives, including serrated knives, cleavers, axes, machetes, and many other cutting tools in about 10 seconds. The large, ergonomic handle fits in either hand and the full-length finger guard safely protects your fingers. The sharpening blades are reversible diamond-honed tungsten carbide that will provide years of reliable use.

MADE IN THE USA



Scan to see how it works.



(001C Case Packs)



(069Tray)



# AccuSharp® Compact Pull-Through Knife Sharpener 6-Piece Tray

The AccuSharp® Compact Pull-Through Knife Sharpener combines our diamond-honed tungsten carbide sharpening blades and fine ceramic rods. This sharpener is perfect for sharpening and maintaining your blades. Available in white/blue and orange/green.



(082Tray)



(083Tray)



Scan to see how it works.

## AccuSharp® Sharp N Easy® 2-Step Knife Sharpener 24-Piece Counter Displays

The AccuSharp® Sharp N Easy® 2-Step Ceramic Knife Sharpener is an innovative tool that anyone can use. The pre-angled ceramic rods are exactly what you need to care for and maintain your blades. The two stages, dark for coarse and white for fine, allow for the proper angle every time.



Scan to see how it works.



Scan to see how it works.



(334CD)



(335CD)

## AccuSharp® 2-Step Carbide-Ceramic Knife Sharpener 24-Piece Counter Displays

The AccuSharp® 2-Step Carbide-Ceramic Knife Sharpener features pre-angled diamond-honed tungsten carbide blades and fine ceramic rods that will maintain an accurate edge. Just three or four strokes through the coarse slot restores the edge, and then 3–4 strokes through the fine rods finishes and polishes the fine edge for a smooth sharp finish. Available in blue/white and blaze-orange.



(343CD)



(345CD)



# AccuSharp® Diamond PRO 2-Step Knife Sharpener 12-Piece Tray

Features pre-angled coarse diamond and fine ceramic rods to sharpen, restore, and then polish a blade's edge. The Diamond PRO 2-Step exterior is made of brushed aluminum and finished with a rubber over-molded grip and rubber feet for safety.

Coarse Grit: 320  
Fine Grit: 1500



(016Tray)



Scan to see how it works.



## AccuSharp® 6-Piece Replaceable Blade Razor Knife Plus Blades PDQ

This counter display accommodates (6) 3.5" knife packages and (6) 3.5" replacement blade packages, available for individual purchase or as a bundle. The replaceable blade razor knife boasts an innovative quick-release lever for easy blade changes and a side push button to lock the blade in three positions (110°, 145°, and 180°) to suit various cutting tasks. Measuring 8.5" when open, the knife features 3.5" 420 stainless steel blades and an ergonomically designed handle for effortless use. Ideal for camping, hiking, or everyday carry, the AccuSharp® Replaceable Blade Razor Knife and Replacement Blades combine exceptional functionality with style.



(745PDQ)



(746PDQ)



## ParaForce® Multi-Tool 18-Piece Counter Display



(800MTS)

The ParaForce® Multi-Tool features 13 tools in one:

- |                         |                              |
|-------------------------|------------------------------|
| 1. Needle Nose Pliers   | 8. Can Opener                |
| 2. Regular Pliers       | 9. Nail Cleaner              |
| 3. Scissors             | 10. Nail File (double-sided) |
| 4. Sharp Knife          | 11. Small Screwdriver        |
| 5. Bottle Opener        | 12. Medium Screwdriver       |
| 6. Phillips Screwdriver | 13. Large Screwdriver        |
| 7. Serrated Knife       |                              |

18-Piece Counter Display: 6-black, 6-blue, 3-orange and 3-yellow

## ParaForce Lockback Knife 18-Piece Counter Display

The ParaForce® Lockback Knife features a belt clip, 3" 420 stainless steel blade, and a safety lock. This handy knife fits comfortably in your pocket and safely in the palm of your hand.



(801LBKS)

### Actual Size:

- 7" Open
- 4" Closed
- 3" Blade



18-Piece Counter Display:

- 6-black
- 6-blue
- 3-orange
- 3-camo



## AccuSharp® Side Kick Floor Display

Each floor stand holds 36 AccuSharp® products and takes minutes to set up. Display as a stand-alone display with base, hang with 'S' clips (provided) or place on a counter or shelf.

Dimensions:  
14" (W) x 59" (T) x 14" (D)  
Interior: 13.5" x 23"



(001C/002C/006C FS) (001C FS)



(006C/101C/1012C FS)



(005C/014C FS)



(014C FS)

## AccuSharp® Wing Rack Floor Display

Let us help you design a display that works for your customers' needs. Display as a stand-alone display with base or hang with 'S' clips (provided).

Dimensions:  
14" (W) x 75" (T) x 14" (D)  
Interior: 13.5" x 47"



## AccuSharp® Rack Display

Approximate Dimensions:

- 14" wide x 7" deep
- 2-Tier unit: 21" tall (30" tall with display card)
- 1-Tier unit: 12" tall (21" tall with display card)

\* Free tier rack display with purchase of 36-pieces



## AccuSharp® Point of Purchase (POP) Display

This simple but effective AccuSharp® acrylic point-of-purchase display unit does a great job of direct selling! Point out the terrific features of these sharpeners without ever saying a word and help increase your sales.

A proven way to increase your AccuSharp® sales.



# STAND OUT to your customers with Custom Imprints!



Ensure your company's name and logo remain prominently displayed to your customers with custom imprints on select AccuSharp® Products. We encourage customers to exercise their creativity by mixing and matching finger guards, ink colors, and sharpener designs to perfectly align with their brand identity. With a vast selection of over 100+ distinct custom combinations at your disposal, crafting the ideal sharpener for YOUR brand has never been easier.

## AccuSharp® Knife & Tool Sharpener

Logo size: 2.31" x .65".  
Minimum order quantity may apply.

In-stock sharpener handle colors:



In-stock finger guard colors:



\*Only white handle colors may substitute finger guard colors.

In-stock ink colors:



## AccuSharp® Compact Sharpeners



Logo size: 1.5" x .5".  
Minimum order quantity may apply.  
Recommended ink colors:



## Sharp N Easy® 2-Step Knife & Tool Sharpener



Logo size: .778" x .4".  
Minimum order quantity may apply.  
Recommended ink colors:



## AccuSharp® SturdyMount® Knife Sharpener



Logo size: .2" x .5".  
Minimum order quantity may apply.  
In-stock ink colors:



## STAND OUT to your customers with Custom Imprints!



Great for:

- Fishermen
- Pools and hot tubs
- Rafting and float tubes
- The beach and lake house

Features:

- It really floats
- Holds 12 cans with ice
- Insulated to keep things cold
- Strong, lightweight, and portable
- Easy to carry
- Built-in handle

Dimensions:

14.25" x 14.25" x 16"



*Showcase your brand at outdoor events with this fun and iconic Big Bobber Floating Cooler by personalizing it with your company logo.*



Minimum order quantity may apply.



# ACCUSHARP®

Keep your edge®



AccuSharp® has been featured or reviewed by these publications:

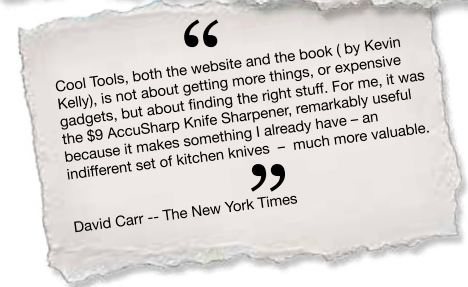

1-830-693-6111 | [www.AccuSharp.com](http://www.AccuSharp.com) | [sales@AccuSharp.com](mailto:sales@AccuSharp.com)

